

WHEEL BOLTS

Wheel Bolts: Serrated

Part #	Thread	Finish Code	A Overall Length	B Thread Length	C Head Diameter	D Serration Diameter	E Shoulder Length	Head Marking	
86797	RH	3/4-16	1	3.02	1.22	1.31	1.00	1.39	
86798	LH		1						
87142	RH	1-1/8-16	1	3.56	1.80	1.50	1.25	1.68	
87143	LH		1						
87319	RH	3/4-16	1	2.51	1.25	1.19	0.81	1.06	
87320	LH		1						
88108	RH	1-1/8-16	1	2.96	1.96	1.50	1.25	1.00	
88109	LH		1						
89085	RH	1-1/8-16	3	2.96	1.96	1.50	1.25	1.00	
89086	LH		3						
89087	RH	1-1/8-16	3	3.27	2.27	1.50	1.25	1.00	
89088	LH		3						
90092	RH	M22X1.5	1	4.13	2.13	1.50	1.25	1.87	092
500000	RH	M22X1.5	1	5.11	3.59	1.69	0.933	1.17	500000
500001	RH	M22X1.5	1	4.11	2.59	1.69	0.933	1.17	500001
500004	RH	M22X1.5	1	3.25	2.01	1.26	0.94	0.91	500004
3018501	RH	M22X1.5	1	4.59	3.35	1.26	0.94	0.91	WQ
3018502	RH	M22X1.5	1	3.17	1.93	1.26	0.94	0.91	WR
3018503	RH	M22X1.5	1	3.66	2.42	1.26	0.94	0.91	WK
3008401	RH	3/4-16	1	2.60	1.28	1.26	0.94	0.98	VK
3008402	LH	3/4-16	1	2.60	1.28	1.26	0.94	0.98	VK
3008709	RH	1-1/8-16	1	3.15	1.91	1.54	1.25	0.96	VH
3008710	LH	1-1/8-16	1	3.15	1.91	1.54	1.25	0.96	VH

Wheel Bolts: Non-Serrated, Clipped Head

Part #	Thread	Finish Code	A Overall Length	B Thread Length	C Head Diameter	D Body Diameter	E Shoulder Length	Head Marking	
88799	RH	M22X1.5	1	4.22	3.06	1.62	0.98	0.85	799
88836	RH	M22X1.5	1	3.58	2.51	1.62	0.98	0.85	836
89620	RH	M22X1.5	1	4.80	3.73	1.62	0.98	0.85	620
90427	RH	M22X1.5	1	3.46	2.17	1.70	1.23	0.94	427
90807	RH	M22X1.5	1	3.20	2.51	1.62	0.98	0.73	807
91100	RH	M22X1.5	1	3.20	2.13	1.62	0.98	0.73	100
90114	RH	3/4-16	1	2.51	1.32	1.62	0.98	0.85	114
90115	LH		1						115
90575	RH	1-1/8-16	1	2.88	1.96	1.70	1.23	0.85	575
90576	LH		1						576
500006	RH	M22X1.5	1	3.42	2.58	1.47	0.89	0.5	500006
500007	RH	M22X1.5	1	4.42	3.58	1.47	0.89	0.5	500007

FINISH CODES:

1-PHOSPHATE & OIL

3-ZINC GOLD DICHROMATE

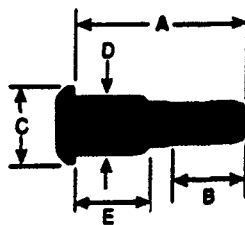

Brake Drums

CentriFuse®
Hub & Drum Assemblies

CentruCast™
Hub & Drum Assemblies

Fasteners